



£119,000

Kipling Road, Willenhall

Flat | 2 Bedrooms | 1 Bathroom

01922 322988



www.remaxlocalestateagents.co.uk



Step Inside

Key Features

- TWO DOUBLE BEDROOMS
- SPACIOUS LOUNGE/DINER
- FITTED KITCHEN
- FIRST-FLOOR MAISONETTE WITH PRIVATE ENTRANCE
- IDEAL INVESTMENT OR FIRST-TIME BUY
- AMPLE STORAGE INCLUDING GROUND FLOOR STORE
- POPULAR SHORT HEATH LOCATION
- LONG LEASE REMAINING (APPROX. 103 YEARS)
- CLOSE TO AMENITIES & TRANSPORT LINKS
- ANNUAL SERVICE CHARGE £400

Property Description

TWO-BEDROOM FIRST-FLOOR MAISONETTE IN A SOUGHT-AFTER LOCATION

Located in the heart of Short Heath, this two-bedroom first-floor maisonette offers fantastic potential for investors or first-time buyers. With two spacious double bedrooms, a large lounge/diner, Refitted bathroom and fitted kitchen, this home provides generous living space.

Situated in a well-maintained development, the property is conveniently placed close to local amenities, transport links, and schools, making it an excellent opportunity for both homeowners and landlords alike.

EPC COMING SOON

Main Particulars

TWO-BEDROOM FIRST-FLOOR MAISONETTE IN A SOUGHT-AFTER LOCATION

Located in the heart of Short Heath, this two-bedroom first-floor maisonette offers fantastic potential for investors or first-time buyers. With two spacious double bedrooms, a large lounge/diner, Refitted bathroom and fitted kitchen, this home provides generous living space.

Situated in a well-maintained development, the property is conveniently placed close to local amenities, transport links, and schools, making it an excellent opportunity for both homeowners and landlords alike.

EPC COMING SOON

Don't miss out on this fantastic investment opportunity! With a long lease, spacious interiors, and a prime location, this property is sure to attract interest. Contact us today to arrange a viewing!

WhatsApp
Image 2025-
06-24 at
15.26.46.jpeg



WhatsApp
Image 2025-
06-24 at
15.26.34.jpeg



WhatsApp
Image 2025-
06-24 at
15.26.31.jpeg



WhatsApp
Image 2025-
06-24 at
15.26.32.jpeg



4 Kipling Road

Approx. 63.0 sq. metres (678.1 sq. feet)

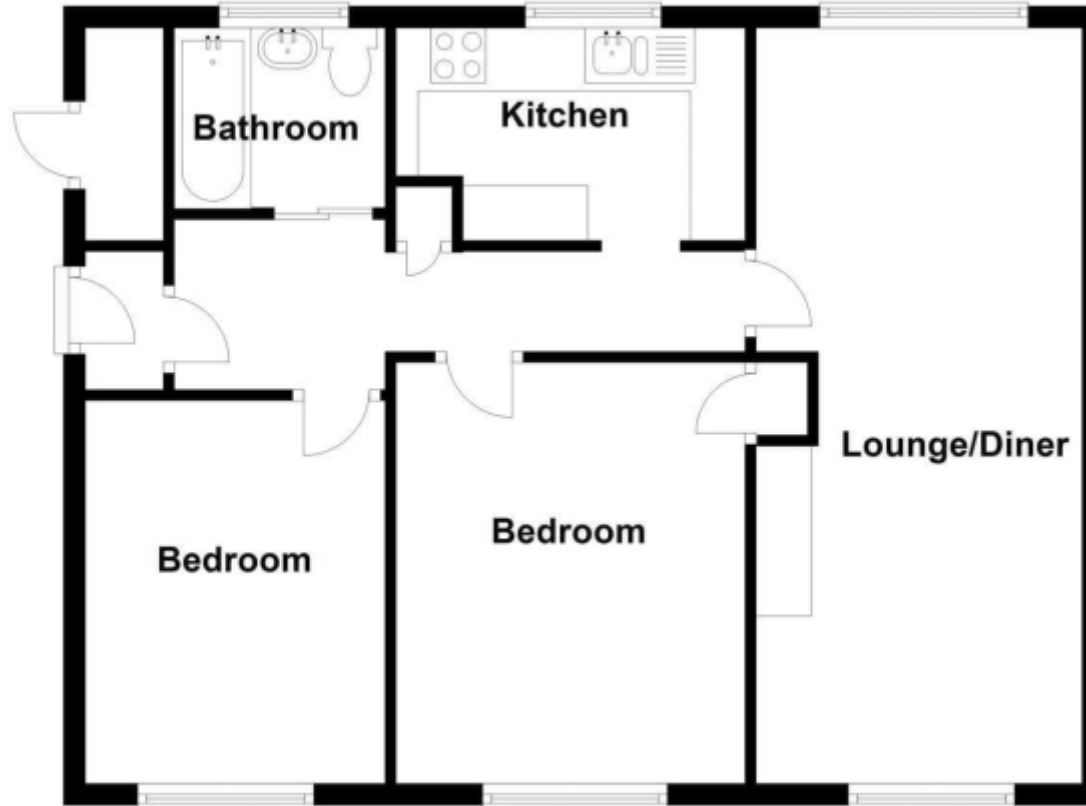

Total area: approx. 63.0 sq. metres (678.1 sq. feet)

Telephone: 01922 322988



www.remaxlocalestateagents.co.uk