



£790 Monthly

High Street, Chesterfield, Old Whittington

Flat | 1 Bedroom | 1 Bathroom

01922 322988



[www.remaxlocalestateagents.co.uk](http://www.remaxlocalestateagents.co.uk)



WARNING  
Do Not Use the Lift in  
the event of a power  
failure

# Step Inside

---

## Key Features

- FULLY REFURBISHED THROUGHOUT
- NEW CARPETS & CONTEMPORARY DECOR
- STUNNING VIEWS
- MODERN KITCHEN WITH AEG APPLIANCES
- WALK-IN SHOWER ROOM
- BUILT-IN BEDROOM STORAGE
- STILTZ LIFT FOR EASY FIRST-FLOOR ACCESS
- QUIET, WELL-MAINTAINED DEVELOPMENT
- OVER 50S

## Property Description

### FULLY REFURBISHED FIRST FLOOR RETIREMENT FLAT

Welcome to Bunting House - a beautifully refurbished one-bedroom first-floor retirement apartment offering modern living with comfort, convenience, and style. Situated in a well-maintained development and benefiting from new carpets, high-spec kitchen appliances, and tranquil surroundings, this property is ideal for those looking for a peaceful and practical home. The development also features a Stiltz lift, providing easier access to first-floor flats.

## Main Particulars

### FULLY REFURBISHED FIRST FLOOR RETIREMENT FLAT

Welcome to Bunting House - a beautifully refurbished one-bedroom first-floor retirement apartment offering modern living with comfort, convenience, and style. Situated in a well-maintained development and benefiting from new carpets, high-spec kitchen appliances, and tranquil surroundings, this property is ideal for those looking for a peaceful and practical home. The development also features a Stiltz lift, providing easier access to first-floor flats.

**Lounge/Dining Room** - 5.10m x 3.50m (16'8" x 11'5") - Bright and airy with large windows offering impressive panoramic views. Freshly carpeted with neutral tones, this generous space is ideal for relaxing or entertaining. Open access to the kitchen.

**Kitchen** - 2.80m x 2.20m (9'2" x 7'2") - Recently fitted with modern white gloss cabinetry, integrated AEG oven and induction hob. Space and plumbing for a washing machine. Window provides natural light and views of the development.

**Bedroom** - 3.60m x 3.00m (11'9" x 9'10") - A spacious double bedroom featuring built-in wardrobe storage. Dual-aspect window with excellent views and fitted with new carpet throughout.

**Shower Room** - 2.50m x 2.00m (8'2" x 6'6") - Modern tiled finish with large walk-in shower, WC, and pedestal basin. Designed for easy access and convenience.

**Hallway** - Provides access to all rooms, finished with new carpet and neutral décor.

To book a viewing or find out more, contact us now. Properties like this are in high demand, so act fast to secure this fantastic flat in Bunting House!



dsc\_2035.jpg



dsc\_2033.jpg



dsc\_2031.jpg



dsc\_2028-  
copy.jpg



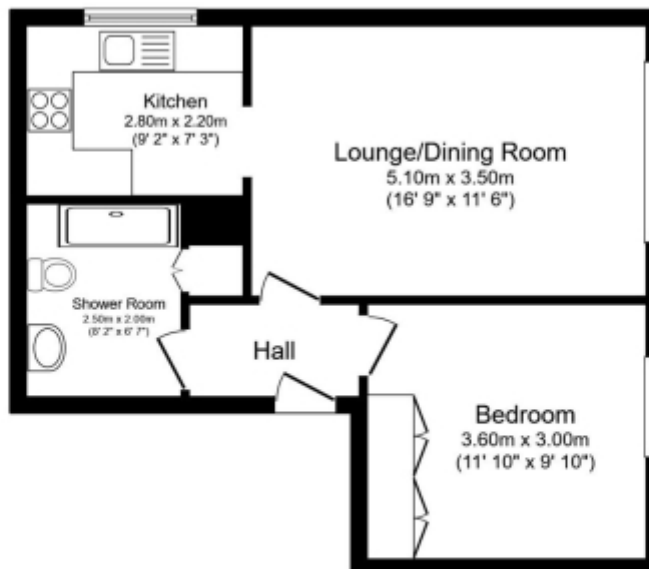

Total floor area 46.0 sq.m. (495 sq.ft.) approx

This floor plan is for illustrative purposes only. It is not drawn to scale. Any measurements, floor areas (including any total floor area), openings and orientation are approximate. No details are guaranteed, they cannot be relied upon for any purpose and they do not form part of any agreement. No liability is taken for any error, omission or misstatement. A party must rely upon its own inspection(s).  
Powered by [www.focalagent.com](http://www.focalagent.com)

This floorplan is for illustrative purposes only and the location of doors, windows and other items are approximate.

Agents notes: All measurements are approximate and for general guidance only and whilst every attempt has been made to ensure accuracy, they must not be relied on. The fixtures, fittings and appliances referred to have not been tested and therefore no guarantee can be given that they are in working order. Internal photographs are reproduced for general information and it must not be inferred that any item shown is included with the property. Copyright © 2025 14430791 Registered Office: , 549 Bloxwich Road, Bloxwich, WS3 2XD

Telephone: 01922 322988



[www.remaxlocalestateagents.co.uk](http://www.remaxlocalestateagents.co.uk)